

Section No	O.D.	W.T.	Periphery mm	Mass kg/m
TU8090	9.53	1.42	60.00	0.098
TU7330	12.70	1.42	39.90	0.136
TU8120	15.88	1.42	49.90	0.174
TU8030	19.05	1.22	59.80	0.185
TU8240	20.00	1.60	62.80	0.251
TU8575	25.00	3.00	78.50	0.562
C4890	31.00	5.00	97.00	1.107
TU8180	31.75	1.42	99.70	0.366
TU8600	31.75	3.00	100.00	3.565
TU8190	38.10	1.42	119.70	0.443
TU8610	38.10	3.00	120.00	0.896
TU8441	40.00	2.00	126.00	0.647
TU8615	40.00	3.00	125.66	0.942
TU8443	50.00	2.00	157.00	0.817
TU8630	50.00	3.00	157.10	1.196
TU8650	57.00	3.00	179.00	1.374
TU8248	50.80	1.60	159.60	0.668
TU8446	60.00	2.00	189.00	0.988
TU8720	63.50	3.25	200.00	1.661
TU8730	76.20	3.25	239.40	1.959
TU8787	76.20	4.75	239.40	2.889
TU8665	100.00	3.00	314.16	2.478

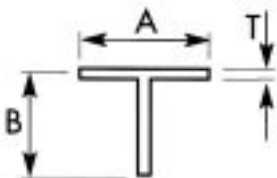

Section No	A	B	T	R	Periphery mm	Mass kg/m
4870	25.00	25.00	3.00		100.00	0.382
1184	50.80	50.80	4.75	6.10	193.00	1.285
1478	63.50	63.50	6.35		248.00	2.123

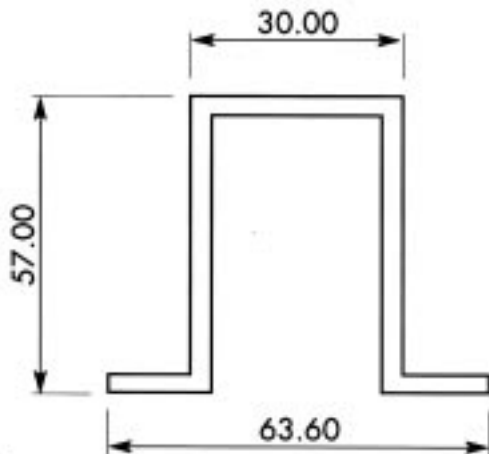

Section No. 5081, 1.798 kg/m, per 358

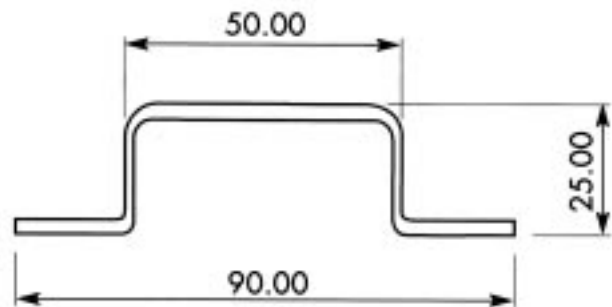

Section No. G481, 0.881 kg/m, per 263

Not to Scale